



College of Alameda

555 Ralph Appezato Memorial Parkway, Alameda, CA 94501
(510) 522-7221 • www.alameda.peralta.edu



TO: College Council

FR: Tim Karas, President College of Alameda

DATE: September 27, 2017

CoA Facilities Master Plan

Introduction

On September 6, 2017 the College held a second campus forum facilitated by Steinberg Architect on the forthcoming CoA Facilities Master Plan. Following the forum an online College wide survey was send to elicit further feedback. The College Executive Cabinet met on September 20, 2017 to review the feedback.

A. Campus Layout

Based on campus feedback from the Open Forum on September 6, 2017 and the campus-wide survey administered September 6, 2017 to September 13, 2107, the College Executive Team met on September 20, 2017 to affirm the recommendation of Option 2 as the preferred draft layout. This recommendation is based that further drafts will be shared with the College based on input received at the campus forums and survey. An example, is to rotate the career center building 90degrees to increase alignment with the main pedestrian axis.

The Mission of College of Alameda to serve the educational needs of its diverse community by providing comprehensive and flexible programs and resources that empower students to achieve their goals.

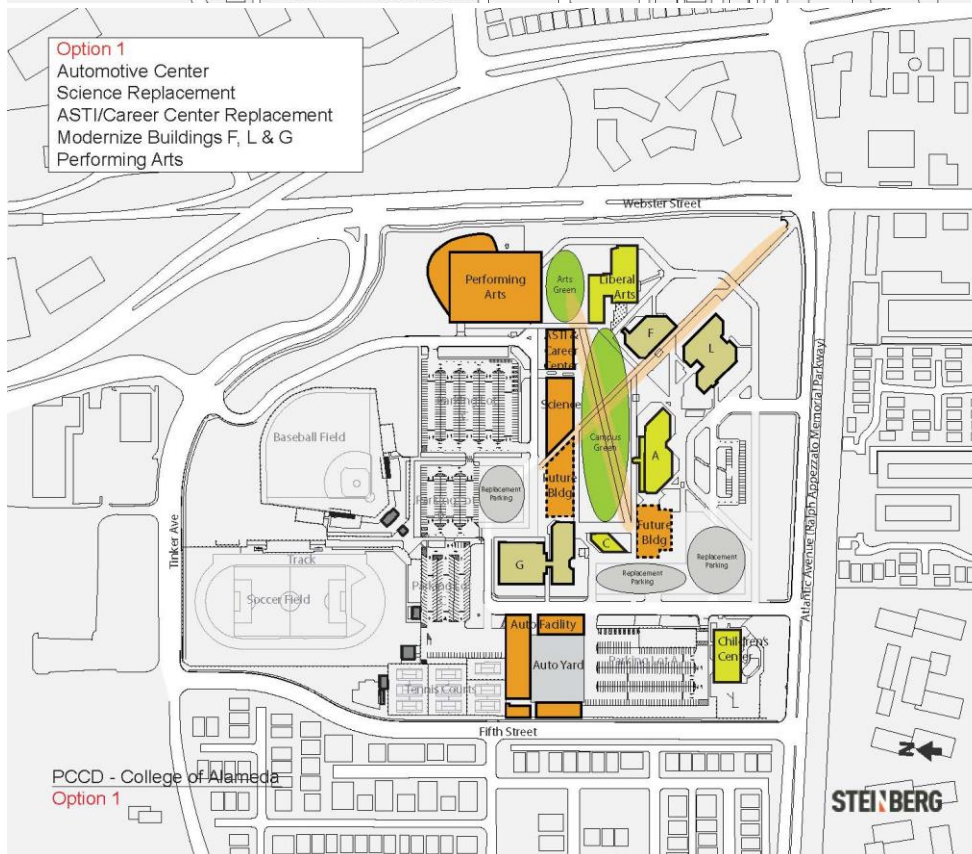
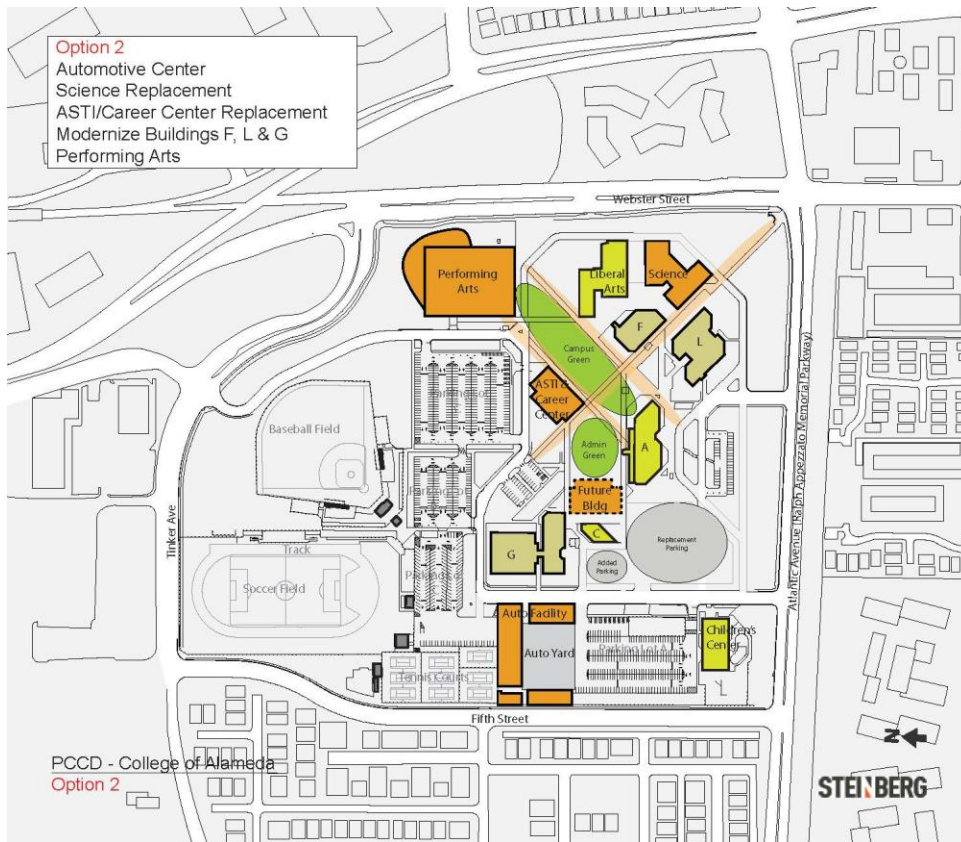

The Mission of College of Alameda to serve the educational needs of its diverse community by providing comprehensive and flexible programs and resources that empower students to achieve their goals.

B. Project Prioritization

A total of 9 projects were identified in the campus forums as potential projects. The campus forums and online survey elicited feedback on the prioritization of the projects. The list below is the draft priority preference.

- Phase 2 C/D Building (Science, DSPS, etc)
- Aviation
- Automotive/Diesel Complex
- Performing Art Center
- Portable Replacement (Career Center, Early College)
- F Building Modernization
- L Building Modernization
- G Building Modernization
- Growth Building

C. Infrastructure Prioritization

Several categories of College wide priorities emerged through the master planning discussion. The topics listed below are not prioritized, however, indicate major areas that need to be emphasized for College improvements. There are items around the topic of total cost of ownership (TCO) that need to be addressed.

- Technology (wired/wireless network infrastructure)
- Computing (Servers)
- Computing (Lab Refreshments)
- SMART Classrooms
- Basic infrastructure (sewer, power, water)
- Drought tolerant landscaping
- Water well for irrigation
- Electric vehicle charging stations
- Solar Panels
- Signage and Wayfinding

The Mission of College of Alameda to serve the educational needs of its diverse community by providing comprehensive and flexible programs and resources that empower students to achieve their goals.